



SHEDS, GARAGES & DRIVEWAY

GUIDELINES

City of New Hope Code Highlights

- "Accessory Structure"**
- Residential zones: Garages and sheds may total 1400 sf
1000 sf max for a single structure
 - One accessory structure in addition to one garage is permitted
 - Buildings must be at least 6 feet from the house or constructed with fire rated walls
 - No buildings may be built or erected upon an easement.
 - Min 5 ft from property lines. Lots with side street have different requirements, check with building and zoning
 - Sheds must be in rear or side yards
 - A small shed (120 sf and under) may be built without a building permit (must comply with building & zoning codes)
 - Shed height is limited to 12' above the ground
 - Sheds must be anchored per code
 - Rear and side setbacks for detached sheds equal 5 feet (does not include corner lots)

- "GARAGES"**
- Maximum garage size is 1,000 sf
 - Garage height is limited to 15 feet
 - Garages are NOT allowed in front yards
 - One garage and one accessory structure allowed
 - Rear setbacks: Detached garage = 10 feet
Attached garage = 25 feet

- "DRIVEWAYS"**
- Driveways and curb cuts/ approaches must be at least 3 feet from the side property line
 - Driveways on corner lots must be 40 feet from intersection of property lines

- " PERMITS"**
- Scaled plans, permit application and fees must be submitted, unless exempt, before work is done.

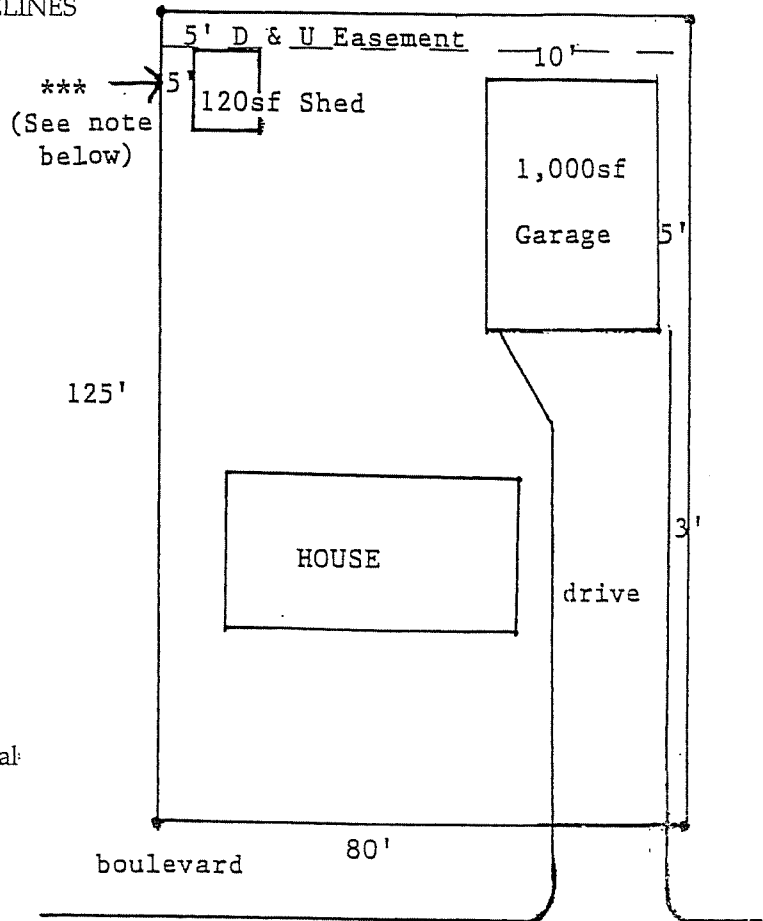

***SOME EXCEPTIONS EXIST. *** Call the New Hope Community Development Department at 763-531-5127 with questions. Actual building and city codes control construction. Boulevard widths vary; Corner lots have different setbacks, etc.